

Cure Dextra® Closed System



The comprehensive line of Cure Medical intermittent catheters includes options for men, women, and children. Benefits associated with Cure Medical catheters include:

- Smooth, fire polished eyelets are designed to provide comfort.
- Products are not made with potentially harmful chemicals such as DEHP/DINP, BPA, or Natural Rubber Latex for safety and peace of mind.
- We support medical research.

CURE DEXTRA® CLOSED SYSTEM

The unisex, Cure Dextra® Closed System is an upgrade to a traditional closed system with proprietary features designed to help enable ease of use:

- **Reinforced Finger Loops** in the package help enable easy opening.
- **A Support Band** on the back of the 1000 ml collection bag helps enable controlled use.
- **Tip Advancing Technology** moves the pre-lubricated catheter into the body without contact – which helps reduce the risk of exposure to bacteria.
- **A Gripper Arrow** is uniquely designed to advance the catheter with each full forward stroke. The catheter does not retract with the full back stroke.

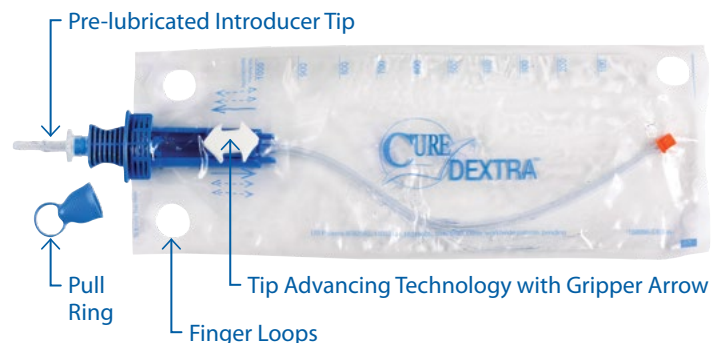

REQUEST SAMPLES

Cure Medical intermittent catheters combine ‘Upgrade Quality’ with ‘Reimbursement Friendly’ availability.* Contact your local distributor of quality healthcare products or visit www.curemedical.com to request complimentary samples to try.

Cure Catheter®

| Part No. | Description | FR Size |
|----------|---|---------|
| HM12 | Hydrophilic, Male, 16", Straight Tip | 12 |
| HM12C | Hydrophilic, Male, 16", Coude Tip | 12 |
| HM14 | Hydrophilic, Male, 16", Straight Tip | 14 |
| HM14C | Hydrophilic, Male, 16", Coude Tip | 14 |
| HM16 | Hydrophilic, Male, 16", Straight Tip | 16 |
| HM16C | Hydrophilic, Male, 16", Coude Tip | 16 |
| HM18C | Hydrophilic, Male, 16", Coude Tip | 18 |
| HM12UK | Hydrophilic, Male, 16", Straight Tip, Kit | 12 |
| HM14UK | Hydrophilic, Male, 16", Straight Tip, Kit | 14 |
| HM16UK | Hydrophilic, Male, 16", Straight Tip, Kit | 16 |
| M8 | Male, 16", Straight Tip | 8 |
| M10 | Male, 16", Straight Tip | 10 |
| M10C | Male, 16", Coude Tip | 10 |
| M12 | Male, 16", Straight Tip | 12 |
| M12C | Male, 16", Coude Tip | 12 |
| M14 | Male, 16", Straight Tip | 14 |
| M14C | Male, 16", Coude Tip | 14 |
| M16 | Male, 16", Straight Tip | 16 |
| M16C | Male, 16", Coude Tip | 16 |
| M18 | Male, 16", Straight Tip | 18 |
| M18C | Male, 16", Coude Tip | 18 |
| F8 | Female, Straight Tip | 8 |
| F10 | Female, Straight Tip | 10 |
| F12 | Female, Straight Tip | 12 |
| F14 | Female, Straight Tip | 14 |
| F14NC | Female, Straight Tip, No Connector | 14 |
| F16 | Female, Straight Tip | 16 |
| F18 | Female, Straight Tip | 18 |
| HP8 | Hydrophilic, Pediatric, 10", Straight Tip | 8 |
| HP10 | Hydrophilic, Pediatric, 10", Straight Tip | 10 |
| HP12 | Hydrophilic, Pediatric, 10", Straight Tip | 12 |
| HP14 | Hydrophilic, Pediatric, 10", Straight Tip | 14 |
| P8 | Pediatric, 10", Straight Tip | 8 |
| P10 | Pediatric, 10", Straight Tip | 10 |
| P12 | Pediatric, 10", Straight Tip | 12 |
| P14 | Pediatric, 10", Straight Tip | 14 |

Cure Catheter® Closed System

| Part No. | Description | FR Size |
|----------|------------------------------------|---------|
| CB8 | Closed System Single, Straight Tip | 8 |
| CB10 | Closed System Single, Straight Tip | 10 |
| CB12 | Closed System Single, Straight Tip | 12 |
| CB14 | Closed System Single, Straight Tip | 14 |
| CB16 | Closed System Single, Straight Tip | 16 |
| CS8 | Closed System Kit, Straight Tip | 8 |
| CS10 | Closed System Kit, Straight Tip | 10 |
| CS12 | Closed System Kit, Straight Tip | 12 |
| CS14 | Closed System Kit, Straight Tip | 14 |
| CS14C | Closed System Kit, Coude Tip | 14 |
| CS16 | Closed System Kit, Straight Tip | 16 |

Cure Dextra® Closed System

| Part No. | Description | FR Size |
|----------|------------------------------------|---------|
| DEX12 | Closed System Single, Straight Tip | 12 |
| DEX14 | Closed System Single, Straight Tip | 14 |
| DEX16 | Closed System Single, Straight Tip | 16 |

Cure Medical® Catheter Insertion Kit

| Part No. | Description |
|----------|-------------------------------------|
| K1 | Insertion Kit |
| K2-100 | Insertion Kit w/universal connector |
| K2-90 | Insertion Kit w/universal connector |

Cure Medical® Extension Tube

| Part No. | Description |
|----------|-------------------|
| ET1 | 29" drainage tube |

Cure Medical® Pocket Catheter

| Part No. | Description | FR Size |
|----------|--------------------------------------|---------|
| M12U | Male, 16", Straight Tip | 12 |
| M12ULC | Male, 16", Coude Tip w/Lubricant | 12 |
| M14U | Male, 16", Straight Tip | 14 |
| M14XL | Male, 25" (Extra Long), Straight Tip | 14 |
| M14UL | Male, 16", Straight Tip w/Lubricant | 14 |
| M14ULC | Male, 16", Coude Tip w/Lubricant | 14 |
| M16U | Male, 16", Straight Tip | 16 |
| M16ULC | Male, 16", Coude Tip w/Lubricant | 16 |
| M14UK | Male, 16", Straight Tip, Kit | 14 |

Cure Twist®

| Part No. | Description | FR Size |
|----------|------------------------------------|---------|
| T8 | Female, Straight Tip | 8 |
| T10 | Female, Straight Tip | 10 |
| T12 | Female, Straight Tip | 12 |
| T14 | Female, Straight Tip | 14 |
| T16 | Female, Straight Tip | 16 |
| T8K | Female, Straight Tip w/Insert. Kit | 8 |
| T10K | Female, Straight Tip w/Insert. Kit | 10 |
| T12K | Female, Straight Tip w/Insert. Kit | 12 |
| T14K | Female, Straight Tip w/Insert. Kit | 14 |
| T16K | Female, Straight Tip w/Insert. Kit | 16 |

Cure Ultra® and Cure Ultra® Plus™

| Part No. | Description | FR Size |
|-------------|--------------------------|---------|
| ULTRA8 | Female, Straight Tip | 8 |
| ULTRA10 | Female, Straight Tip | 10 |
| ULTRA12 | Female, Straight Tip | 12 |
| ULTRA14 | Female, Straight Tip | 14 |
| ULTRA16 | Female, Straight Tip | 16 |
| ULTRAPLUS8 | Female, 8", Straight Tip | 8 |
| ULTRAPLUS10 | Female, 8", Straight Tip | 10 |
| ULTRAPLUS12 | Female, 8", Straight Tip | 12 |
| ULTRAPLUS14 | Female, 8", Straight Tip | 14 |
| ULTRAPLUS16 | Female, 8", Straight Tip | 16 |
| ULTRA M8 | Male, 16", Straight Tip | 8 |
| ULTRA M10 | Male, 16", Straight Tip | 10 |
| ULTRA M10C | Male, 16", Coude Tip | 10 |
| ULTRA M12 | Male, 16", Straight Tip | 12 |
| ULTRA M12C | Male, 16", Coude Tip | 12 |
| ULTRA M14 | Male, 16", Straight Tip | 14 |
| ULTRA M14C | Male, 16", Coude Tip | 14 |
| ULTRA M16 | Male, 16", Straight Tip | 16 |
| ULTRA M16C | Male, 16", Coude Tip | 16 |
| ULTRA M18 | Male, 16", Straight Tip | 18 |
| ULTRA M18C | Male, 16", Coude Tip | 18 |

REQUEST COMPLIMENTARY SAMPLES TODAY!